

2013 Annual Meeting Program

Papers to be presented at the 46th Annual Meeting of the Ichthyological Society of Japan at **Miyazaki Kanko Hotel**,
Miyazaki, October 3-6, 2013

Oral Presentations

(Each presentation has been allowed 15 min, i.e. 12 min for presentation and 3 min for questions; *speaker)

Oral Presentation Room #1 (Hiyo Room, 3rd Floor of East Building)

October 4 (Friday)

Systematics

- 1 9:00- Revision of the *Scolecenchelys gymnota* species group (Ophichthidae: Myrophinae). Yusuke HIBINO* and Seishi KIMURA.
- 2 9:15- Classification of the genus *Misgurnus* (Cypriniformes, Cobitidae) in Japan. Jun NAKAJIMA*, Yasuyuki HASHIGUCHI, Tomofumi NAKAMURA and Yuzuru SUZAWA.
- 3 9:30- Taxonomic review of the genus *Hypoatherina* (Atheriniformes: Atherinidae). Seishi KIMURA* and Daichi SASAKI.
- 4 9:45- An undescribed species of the genus *Pterois* (Scorpaenidae: Pteroinae) from the western Pacific Ocean. Mizuki MATSUNUMA* and Hiroyuki MOTOMURA.
- 5 10:15- A new species of the genus *Selenanthias* (Serranidae) from the Okinawa Trough, Japan. Takeshi YAMAKAWA* and Hiromitsu ENDO.
- 6 10:30- Review of the genus *Pempheris* in the Indian Ocean. Keita KOEDA*, Tetsuo YOSHINO and Katsunori TACHIHARA.
- 7 10:45- Taxonomic status of all nominal species belonging to the genus *Enneapterygius* (Tripterygiidae) in Japan. Masatoshi MEGURO* and Hiroyuki MOTOMURA.
- 8 11:00- Validity of *Helcogramma ishigakiensis* (Aoyagi, 1954) and assessment of standard Japanese name for the species. Satokuni TASHIRO* and Hiroyuki MOTOMURA.

<Lunch Break>

Systematics and Phylogeny

- 9 14:30- Genetic and morphological divergence between *Lethotremus awae* from the Pacific and Sea of Japan coasts of Japan. Yoshiaki KAI*, Shin-ichiro IKEGUCHI and Tetsuji NAKABO.
- 10 14:45- Genetic population structures of *Crystallichthys matsushimae* (Liparidae) inferred from AFLP. Akira TOHKAIRIN*, Yoshiaki KAI, Yuji UEDA, Tomonori HAMATSU, Masaki ITO and Tetsuji NAKABO.
- 11 15:00- Phylogenetic position of the family Abyssocottidae (Cottiformes). Yoshiko SASAKI*, Hisashi IMAMURA and Mamoru YABE.
- 12 15:15- Taxonomy and identification of *Gymnogobius castaneus* complex in Japan. Koichi SHIBUKAWA*, Takahiko MUKAI and Satoru CHIBA.

- 13 15:30- A review of the pufferfish genus *Torquigener* Whitley, 1930 with comments on an undescribed species building “mystery circles” on the sandy bottom in Amami-ohshima Island, Ryukyu Islands. Keiichi MATSUURA.
- 14 15:45 Variations in Maturation and Morphology of *Diodon holocanthus* from the East China Sea. Minoru TODA*, Kei MIYAMOTO, Yusuke YAMANOUE, Masaru NAKAMURA and Keiichi MATSUURA.

<Short Break>

Genetic Structure

- 15 16:15- Analysis of genetic population structure of Akame in Kochi Prefecture using microsatellite DNA markers. Shusaku UEDA*, Hirohiko TAKESHIMA, Hiroshi TAKAHASHI, Hideaki TANOUE, Kouji NAKAYAMA and Teruhisa KOMATSU.
- 16 16:30- Reinvestigation of native landlocked masu salmon of the southernmost border, Kyushu Island, Japan. Naoki SUENAGA*, Toshinao INENO, Fumiya TANAKA and Yukio IWATSUKI.
- 17 16:45- Genetic characteristics of native landlocked masu salmon, *Oncorhynchus masou masou*, of Kyushu Island, Japan—Why can’t we meet Saramao masu strain, *O. masou formosanus*, in Kyushu Island? – Yukio IWATSUKI*, Naoki SUENAGA, Fumiya TANAKA and Toshinao INENO.

October 5 (Saturday)

Phylogeny and Systematics

- 18 9:00- Reconstruction of the interrelationships of the family Congridae (Anguilliformes). Shinta SAKURAI*, Hisashi IMAMURA and Mamoru YABE.
- 19 9:15- Interrelationships of Aulopidae based on osteological characters. Sei KAWABATA* and Kazumi HOSOYA.
- 20 9:30- Morphological revision of a close relationship of the orders Lophiiformes and Tetraodontiformes. Kosuke IKEDA*, Hisashi IMAMURA and Mamoru YABE.
- 21 9:45- Phylogenetic position of *Carangoides ferdau* and *Carangoides orthogrammus*, and their morphological characteristics (Perciformes: Carangidae). Shun TAKEUCHI* and Seishi KIMURA.

<Short Break>

Phylogeny and Genetics

- 22 10:15- Genetic characteristics of congeners of the genus *Pagrus* (Perciformes; Sparidae) from the western Pacific. Fumiya TANAKA* and Yukio IWATSUKI.
- 23 10:30- Interrelationships of *Astrabe* group based on osteological characters. Daiki OKUMURA* and Kazumi HOSOYA.
- 24 10:45- Establishing massive analysis procedures of fish mitogenomes using next generation sequencing. Hirohiko TAKESHIMA*, Shotaro HIRASE, Wataru IWASAKI, Ryoichi TABATA, Katsutoshi WATANABE and Mutsumi NISHIDA.

- 25 11:00- Improvement of a fish mitochondrial genome database, MitoFish, by the implementation of a powerful automatic annotation pipeline, MitoAnnotator. Mutsumi NISHIDA*, Tsukasa FUKUNAGA, Ryota ISAGOZAWA, Koichiro YAMADA, P. Takashi SATOH, Tetsuya SADO, Masaki MIYA, Hirohiko TAKESHIMA, Kohji MABUCHI, Yasunobu MAEDA and Wataru IWASAKI.

<Short Break>

Phylogeny and Genetics

- 26 11:30- Genetic composition of polyploid *Carassius* fish in Lake Biwa, central Japan. Tappei MISHINA*, Ryoichi TABATA, Mitsunori NAKANO, Mikumi TAKADA, Hirohiko TAKESHIMA, Mutsumi NISHIDA and Katsutoshi WATANABE.
- 27 11:45- Larvae of deep-water snappers collected off south of Okinawa-jima Island and species identification using DNA barcoding. Kensuke IWAMOTO* and Masato UEHARA.
- 28 12:00- The last glacial impacts on deep-sea demersal fishes. Kay SAKUMA*, Yuji UEDA and Shigeaki KOJIMA.
- 29 12:15- Comparative phylogeography of coastal fishes in the South China Sea: a preliminary report. Nozomu MUTO*, Akira TAKAGI, Hiroyuki MOTOMURA, Yuka OGATA, Somnuk PORNPATIMAKORN, Ricardo BABARAN, Takashi SATOH, Hirohiko TAKESHIMA, Fumihito MUTO and Satoshi ISHIKAWA.

<Lunch Break>

Distribution, Genetics and Morphology

- 30 14:30- Discovery of substantial continental habitats of sicydiine goby. Ken MAEDA* and Hau Duc TRAN.
- 31 14:45- Ichthyofauna of Minami-Daito (South Borodino) Island, one of the few oceanic islands in Japan. Kaoru KURIIWA*, Satoru CHIBA, Mizuki MATSUNUMA and Keiichi MATSUURA.
- 32 15:00- Phylogeography of coastal fishes in the Daito Islands—A preliminary analysis on the Wrought iron butterflyfish. Satoru N. CHIBA*, Ryo O. GOTOH, Kaoru KURIIWA and Keiichi MATSUURA.
- 33 15:15- Significance of the Langsdorff Collection in the Zoological Institute of Russian Academy of Sciences, St. Petersburg, in the history of ichthyology. Yuko TAKIGAWA* and TETSUO YOSHINO.
- 34 15:30- Morphological diversity of the cephalic clasper in Chimaeriformes. Keisuke OGIMOTO*, Toshio KAWAI and Mamoru YABE.
- 35 15:45- Development of the lateral line system in *Rhinogobius flumineus* (preliminary report). Masanori NAKAE* and Akira KURASHIMA.
- 36 16:00- The origin of superficial neuromast rows in gobioids. Ryu ASAOKA* and Kunio SASAKI.

Oral Presentation Room #2 (Hekiyo Room, 3rd Floor of East Building)

October 4 (Friday)

Conservation and Ecology

- 37 9:00- Comparison of artificial maturation effect of abstract from salmon pituitary and sex hormone for Chinese rosy bitterling *Rhodeus ocellatus ocellatus*. Yuka ODA*, Tetsuro KITAGAWA, Kengo HATADA and Kazumi HOSOYA.

- 38 9:15- Swimming behavior of sculpin (*Cottus pollux*) and flow characteristics around the weir. Keiko MURAOKA*, Satoru NAKANISHI and Yuichi KAYABA.
- 39 9:30- Habitat recovery of *Tachysurus tokiensis* in the paddy field pond with small artificial reef made from thinned wood. Naoyuki SUGURO*, Shun ANZAI and Hidetaka SUMIKURA.
- 40 9:45- Recovery stage of Red spotted Masu Salmon from disturbance by typhoon in a mountain stream. Hirotaka NARASHIMA*, Satoru MATSUMURA, Hiromitsu SAITOH, Kounosuke TAKAHASHI, Ryouta KIKUCHI, Kazuhiko NAKAMICHI, Mitsuo HASEGAWA and Izumi AKAGAWA.

<Short Break>

Conservation and Ecology

- 41 10:15- Current status of the Ryukyu ayu-fish *Plecoglossus altivelis ryukyuensis* in the Genka River, Okinawa, Japan. Shin-ichiro OKA and Kei MIYAMOTO*.
- 42 10:30- Eradication of largemouth bass fry by dip net, seine net and roll net. Jun ASHIZAWA*, Yasufumi FUJIMOTO, Katsutoshi SUZUKI, Masatoshi HOSHI and Tetsuo SHIMADA.
- 43 10:45- Decrease of population size and increase of 0+ body size of largemouth bass *Micropterus salmoides* by control activity in Lake Izunuma-Uchinuma. Yasufumi FUJIMOTO*, Jun ASHIZAWA, Tetsuo SHIMADA and Kiyotaka TAKAHASHI.
- 44 11:00- Artificial spawning device, inducing spawning of largemouth bass: improvement and evaluation. Katsuki NAKAI.

<Lunch Break>

Session :The evolutionary and ecological research of fishes in Lake Biwa: the present and perspective

- 4 14:30- Studies on the endemic fauna of Lake Biwa: a retrospective. Katsutoshi WATANABE.
5
- 46 14:45- The origin and evolution of endemic fishes in Lake Biwa, with special reference to mitochondrial adaptation. Ryoichi TABATA*, Hirohiko TAKESHIMA, Shotaro HIRASE, Mutsumi NISHIDA, Ryo KAKIOKA, Takefumi KOMIYA and Katsutoshi WATANABE.
- 47 15:00- Lake Biwa as a refuge of native Japanese common carp. Kohji MABUCHI*, Hayeun SONG, Hirohiko TAKESHIMA, Katsuki NAKAI, Hiroshi SENOU and Mutsumi NISHIDA.
- 48 15:15- Stable isotope reveal polymorphism of migratory behavior in a Lake Biwa population of AYU. Yoichiro SAKAI*, Tomohiro TAKEYAMA, Zin-ichi KARUBE, Ichiro TAYASU and Noboru OKUDA.
- 49 15:30- Adaptation to the limnetic environment of Lake Biwa: exploring the genetic basis of the diverged morphology in *Gnathopogon* (Cyprinidae). Ryo KAKIOKA*, Tomoyuki KOKITA, Hiroki KUMADA, Katsutoshi WATANABE and Noboru OKUDA.
- 50 15:45- The utility of biological specimens in ichthyology: to explore past, present and future Lake Biwa. Noboru OKUDA.

<Short Break>

Physiology, Genetics, and Ecology

- 51 16:15- Sound producing system in spotnape ponyfish, *Nuchequula nuchalis* (Perciformes: Leiognathidae): its sound characteristics and the sound producing mechanism. Takumi KOJIMA* and Hiroaki SOMIYA.

- 52 16:30- Identification of QTL determining male reproductive strategy of threespine sticklebacks. Tomoyuki KOKITA*, Hatsune NONOGAKI and Seiichi MORI.
- 53 16:45- Sex ratio of adult Japanese seabass *Lateolabrax japonicus* varying according to a fishing place, Oita Pref. Masaaki KAGEHIRA.

Oral Presentation Room #2 (Hekiyo Room, 3rd Floor of East Building) October 5 (Saturday)

Ecology and Ethology

- 54 9:00- Ecology of *Lefua echigonia* in the headwaters of the Tatarazawa, Atsugi City. Hidetaka SUMIKURA.
- 55 9:15- Stable isotope ratios of carbon and nitrogen in fishes of a reservoir in Gifu Prefecture. Taiga YODO*, Akira NONOME, Hiroaki KITAMURA, Ryota TAKAKURA and Yoshito NAKANISHI.
- 56 9:30- Feeding habitats of golden venus chub *Hemigrammocypris rasborella* in an irrigation pond. Noriyasu SUZUKI*, Yoshiyuki MUKAI, Taisuke OHTSUKA, Emi HATAKEYAMA and Yasushi HARADA.
- 57 9:45- Life history polymorphism in male and both sexes in anadromous fishes: what differences do they have? Akira GOTO* and Takefumi KITAMURA.

<Short Break>

Ecology and Ethology

- 58 10:15- Biology of a cottoid fish, *Pseudoblennius argenteus*, in Nakanoshima, Shimane Prefecture. Kenta SUDA.
- 59 10:30- Remating tactics of widowed males in a polygynous fish *Labroides dimidiatus* (2). Tetsuo KUWAMURA*, Tatsuru KADOTA and Shohei SUZUKI.
- 60 10:45- Feeding ecology and relationship with barbel morphology of Mullidae. Shota SAMEJIMA* and Katsunori TACHIHARA.
- 61 11:00- Mating system and protogynous sex change in *Epinephelus bruneus* (Serranidae). Haruka NOGIWA*, Kan SHIOTA and Tomoki SUNOBE.

<Short Break>

Conservation and Ecology

- 62 11:30- Maturation and microhabitat use of *Mugilogobius chulae* and *Mugilogobius* sp. at Sashiki and Manko tidal flats, Okinawa-jima Island, Japan. Taiga KUNISHIMA* and Katsunori TACHIHARA.
- 63 11:45- Habitat selection and maturation process in the Picasso triggerfish *Rhinecanthus aculeatus*. Fabienne ZIADI-KÜNZLI* and Katsunori TACHIHARA.
- 64 12:00- Replacement of nonnative rainbow trout by nonnative brown trout in Chitose River, Hokkaido. Koh HASEGAWA*, Hideyuki KAWAI and Nobuo ISHIYAMA.
- 65 12:15- Geographical variation in the number of pectoral fin rays in Ayu. Keiichiro IGUCHI.

<Lunch Break>

Ethology and Ecology

- 66 14:30- Why anemonefishes are monogamous? Tests for hypotheses on intrasexual competition in *Amphiprion ocellaris*. Tomoki SUNOBE*, Chenhao SHI and Tetsuo KUWAMURA.
- 67 14:45- Gonadal structure and protandrous sex change in the sandbrower fish *Limnichthys fasciatus*. Toshiaki SHITAMITSU* and Tomoki SUNOBE.
- 68 15:00- Spawning behavior and features of eggs of the needle fish *Tylosurus crocodilus*. Hiroshi KAWASE* and Sigeru HARAIZAKI.
- 69 15:15- Mate choice and male-male competition of frogfish *Antennarius striatus*. Taiki TAKAHASHI*, Akishige SUGURI, Masato TODATE, Hiroyasu SUZUKI and Izumi AKAGAWA.
- 70 15:30- Review on the reproductive behavior of *Channa argus*. Takuya SATO*, Koji YOSHIKAWA and Izumi AKAGAWA.
- 71 15:45- Influence of choosing burrow and mate on behavior in *Ptereleotris hanae*. Shoko SUZUKI*, Mizuki KIMURA, Nagisa SHIRAI, Fumihito IWASE, Masao NAKANO and Izumi AKAGAWA.
- 72 16:00- The cost of doing business: factors influencing reproductive success at a spawning aggregation site. Terry J. DONALDSON*, Marylou H. STAMAN and Taryn MESA.

<Short Break>

Ecology and Conservation

- 73 16:30- Ecology of pale chub immigrated into rivers in the Chubu and Tohoku regions. Osamu KATANO*, Kouichi KAWAMURA and Yoshihiro BABA.
- 74 16:45- Field works using high resolution aerial photograph as a map: can we predict where is the site with high species richness of damselfish assemblages? Akihisa HATTORI* and Takuro SHIBUNO.
- 75 17:00- Effects of human-made obstructions on the distribution and density of the amphidromous sculpin in Fukui Prefecture. Daisuke TAHARA* and Yusuke IWASAKI.

Oral Presentation Room #1 (Hiyo Room, 3rd Floor of East Building)

October 5 (Saturday)

Resources and Ecology

- 76 16:30- The recover sign of Japanese sardine resources in the southwest Sea of Japan. Masanori ODA*, Tsuyoshi SHIMURA, Taro OOTA, Yukio ISHIHARA, Masaaki FUKUWAKA and Seiji OOSHIMO.
- 77 16:45- The third quadrant hypothesis for the spawning sites of the Japanese eel. Shun WATANABE*, Jun AOYAMA, Michael J. MILLER, Noritaka MOCHIOKA, Tsuguo OTAKE, Tatsuki YOSHINAGA, Makoto OKAZAKI and Katsumi TSUKAMOTO.

Poster Presentations

(Core-time: 13:30-14:30 on October 4 for odd-numbered papers and on October 5 for even-numbered papers;
*corresponding author)

Poster Presentation Room #3 (Suiyo Room, 3rd Floor of East Building)

- 78 Otoliths of clupeid fishes – comparative study for identification –. Shota MITSUI*, Masashi YOKOTA and Carlos A. STRUSSMANN.
- 79 Morphological revision of a close relationship of the orders Gadiformes and Zeiformes. Kyoji MORITA*, Hisashi IMAMURA and Mamoru YABE.
- 80 A presumed natural hybrid between two Korean ricefishes, *Oryzias latipes* and *O. sinensis*. Hyun-Tae KIM, Yong-Joo LEE and Jong-Young PARK.
- 81 Building a biomimetics database with comments on body surface structures of the Tetraodontiformes. Gento SHINOHARA, Eri KATAYAMA*, Fumihito TASHIRO, Keiichi MATSUURA and Toshio KAWAI.
- 82 Is the giant moray eel one species or multiple species? –Conclusion based on leptocephalus morphologies and genetic analysis–. Atsushi TAWA* and Noritaka MOCHIOKA.
- 83 A species of the genus *Haptenchelys* (Anguilliformes: Synphobranchidae) collected from deep-sea bottom of the Pacific side of Japan. Fumihito TASHIRO* and Gento SHINOHARA.
- 84 Two undescribed species of the genus *Encrasicholina* (Engraulidae) from the Red Sea. Harutaka HATA* and Hiroyuki MOTOMURA.
- 85 An undescribed *Glossanodon* species collected from off Western Australia (Argentinidae). Hiromitsu ENDO* and Peter LAST.
- 86 Taxonomic study on the family Myctophidae collected from Peru. Hirotaka SATO*, Hisashi IMAMURA and Mamoru YABE.
- 87 An undescribed *Neoscopelus* species from Northwest Australia and off New Zealand (Neoscopelidae). Takashi SUZUKI* and Hiromitsu ENDO.
- 88 An undescribed species of *Nezumia* from the Dampier Seamounts in the eastern central Atlantic (Gadiformes: Macrouridae). Naohide NAKAYAMA* and Hiromitsu ENDO.
- 89 First Japanese record of the adult gibberfish from Yoron Basin and phylogenetic position of the Gibberichthyidae. Takashi P. SATOH* and Eri KATAYAMA.
- 90 Synonymy of two species and a new species of the genus *Bassozetus* (Ophidiidae). Shin-ichi TOMIYAMA*, Munehiro TAKAMI and Atsushi FUKUI.
- 91 Genetic and morphological differences between *Halieutaea stellata* and *H. sp.* Yoshihiro TAKADA*, Yoshiaki KAI and Naoki YAGISHITA.
- 92 Taxonomic status of the Indo-Pacific scorpionfish, *Scorpaenodes guamensis* (Scorpaenidae). Hiroyuki MOTOMURA*, Romain CAUSSE and Carl STRUTHERS.
- 93 Morphological difference of two populations of *Ditrema jordani*. Hiroshi KATAFUCHI*, Yoshiaki KAI and Tetsuji NAKABO.
- 94 Review of the stonefish genus *Minous* (Synanceiidae). Gota OGIHARA* and Hiroyuki MOTOMURA.

- 95 First Japanese record of the apogonid fish, *Neamia notula*, from Okinawa Prefecture, Japan. Tomohiro YOSHIDA*, You SAKURAI and Hiroyuki MOTOMURA.
- 96 Genetic status of three rare lutjanid species and genetic distinction between the Pacific and the Indian Ocean of *Lutjanus madras*. Kento TSUZAKI*, Fumiya TANAKA and Yukio IWATSUKI.
- 97 Taxonomical study of the genus *Gymnocranius* of the Lethrinidae from Japan. Ryohei MIKI* and Yukio IWATSUKI.
- 98 Japanese records and standard Japanese names of *Chromis analis* and *C. xouthos* (Perciformes: Pomacentridae). Hiroki IWATSUBO* and Hiroyuki MOTOMURA.
- 99 An undescribed species of the genus *Terelabrus* from the western Pacific Ocean. Yoshino FUKUI*, Shin-ichi DEWA and Hiroyuki MOTOMURA.
- 100 Taxonomic status of *Trichiurus lepturus* Linnaeus 1758 (Pisces: Trichiuridae). Koichi HIDAKA*, Youichi TSUKAMOTO and Yukio IWATSUKI.
- 101 Interrelationships and conservation of *Biwia* and *Microphysogobio* (Cyprinidae; Gobioninae). Seigo KAWASE* and Kazumi HOSOYA.
- 102 Phylogenetic analysis of the genus *Gerres*. Nana HAYASHIDA*, Fumiya TANAKA and Yukio IWATSUKI.
- 103 Evaluation of the monophyly of the family Polynemidae (order Perciformes). Shihua KANG*, Hisashi IMAMURA and Mamoru YABE.
- 104 A comprehensive phylogeny and diversification process of the gobioid fishes revealed by whole mitogenome sequences with supermatrix analysis. Takeshi KON*, Tetsuya SADO, Lukas RUBER, Takashi P. SATOH, Tetsuo YOSHINO, Mutsumi NISHIDA and Masaki MIYA.
- 105 Population structure of gizzard shad *Konosirus punctatus* in Korea and Japan inferred from mitochondrial DNA analysis. Woo-Seok GWAK, Dong-Hoon HAN and Kouji NAKAYAMA*.
- 106 Population structure of *Tribolodon nakamurai* and related species based on mitochondrial and microsatellite DNA. Jun-ichi IMOTO*, Aya ITO-SEKIMOTO, Kiyotaka SHIBATA, Takeshi SASAKI, Hidetoshi TAMATE and Naoto HANZAWA.
- 107 Loss of the lateral plates in a Japanese threespine stickleback population has a novel genetic basis. Yuto SUZUKI*, Seiichi MORI and Tomoyuki KOKITA.
- 108 Introgressive hybridization between Japanese and Chinese temperate bass in Korea and China. Ryo YAMADA*, Kouji NAKAYAMA and Woo-Seok GWAK.
- 109 Genetic divergence in the roughskin sculpin inferred from mitochondrial DNA control region. Naoya ISHIGURO*, Kentaro FUJITA, Daisuke TAHARA and Naohiko TAKESHITA.
- 110 Ecological factors on population genetic structure formation in three species of *Acentrogobius*. Shoko MATSUI*, Kouji NAKAYAMA, Yoshiaki KAI and Yoh YAMASHITA.
- 111 Identification of natural hybrids between *Takifugu snyderi* and *T. stictonotus* by AFLP markers. Hiroshi TAKAHASHI*, Airi TOYODA, Tsuyoshi MASHIKO and Yukio YAMAZAKI.
- 112 Checklist of marine fishes from Phuket and Ranong, Thailand. Veera VILASRI, Tomoyuki YAMANAKA, Shuhei TOCHINO, Toshio KAWAI*, Sahat RATMUANGKHWANG and Hisashi IMAMURA.

- 113 Rays of Kochi, southern Shikoku Island, Japan –A revised checklist based on specimens–. Ryo MISAWA* and Hiromitsu ENDO.
- 114 Distribution patterns of Antarctic myctophid *Electrona antarctica* in the East Antarctica. Kentaro FUJII*, Chieko WAKAHARA, Motoha OZIMA, Kunio TAKAHASHI, Atsushi TANIMURA and Masato MOTTEKI.
- 115 Soles (Pleuronectiformes: Soleidae) from the southern South China Sea. Byeol JEONG* and Hiroyuki MOTOMURA.
- 116 Relationship between Tsushima Current Area and fish fauna in shallow sea area around coastal Tsuyazaki, Fukuoka Prefecture: Analysis of fish database throughout a practical program on biological fieldwork. Norio ONIKURA*, Takashi NISHIDA, Ryutei INUI and Shin OIKAWA.
- 117 Influence of the construction of Haneda new runway for ichthyofauna in Tama River estuary, Tokyo Bay. Tomohiko SEKIZAWA*, Masato MOTTEKI and Hiroshi KOHNO.
- 118 Reproduction of Asian fresh and brackish water puffers in aquaria of Shimonoseki Marine Science Museum. Hiroyuki DOI*, Takayuki SONOYAMA, Toshiaki ISHIBASHI and Harumi SAKAI.
- 119 Eggs and larvae of an undescribed pufferfish of the genus *Torquigener* building “mystery circles” on a sandy bottom on the south coast of Amami-oshima Island. Takayuki SONOYAMA*, Hiroyuki DOI, Satoru N. CHIBA, Keiichi MATSUURA and Toshiaki ISHIBASHI.
- 120 The role of aquatic vegetation as fish refugia from highly turbid water. Ryota KAWANISHI*, Terutaka MORI, Yukio ONODA, Akihiro UMEMOTO, Yasumitsu KATO and Yuichi KAYABA.
- 121 Utilization of burrows of *Upogebia yokoyai* and *Nihonotrypaea japonica* by the near threatened goby *Eutaeniichthys gilli*. Yumi HENMI* and Gyo ITANI.
- 122 Spawning migration of Honmoroko *Gnathopogon caeruleus* from Lake Biwa to Iba-naiko Lagoon. Takeshi KIKKO*, Haruo OKAMOTO, Muneji UJIE, Jin SAEGUSA, Daisuke ISHIZAKI, Yasuhiro FUJIOKA and Yoshiaki KAI.
- 123 Freshwater fishes occurring in the Koga Irrigation Canal, Kyoto. Kazuhiro TANAKA*, Seigo KAWASE, Kouichi TSUJI, Masayuki SUDO and Kazumi HOSOYA.
- 124 Breeding migration of catfish *Silurus asotus* in the waters of consolidated farmland, Tochigi Prefecture. Akira MORI*, Masakazu MIZUTANI and Akira GOTO.
- 125 Downstream migration of Japanese dace in inlet of Lake Biwa. Daisuke ISHIZAKI*, Takamaru NAGATA, Toshiaki MIZUNO, Takuya OKUBO, Takeshi KIKKO and Taiga YODO.
- 126 Hybridization and introgression between *Tanakia lanceolata* and *T. limbata* in Matsuyama plain. Hideki MATSUBA*, Kaito OUCHI, Shotaro YOSHIMI and Hiroki HATA.
- 127 Occurrence patterns and food habits of dominant gobiids in Tama River estuary, Japan. Ryota WATANABE*, Masato MOTTEKI and Hiroshi KOHNO.
- 128 How do the fishes utilize the tidal flat in Tama River estuary, the inner Tokyo Bay? : Part I Long-term changes of life style categories. Chihiro KAKUBARI*, Masato MOTTEKI and Hiroshi KOHNO.
- 129 Biological traits of *Argyrops bleekeri* in coastal water around Okinawa Island. Masato UEHARA*, Itaru OHTA, Akihiko EBISAWA and Katsunori TACHIYAMA.
- 130 How do the fishes utilize the tidal flat in Tama River estuary, the inner Tokyo Bay? : Part II Life style categories and occurrence patterns of dominant species. Yuki SAITO*, Masato MOTTEKI and Hiroshi KOHNO.

- 131 Migration of yellowfin goby *Acanthogobius flavimanus* in the inner Tokyo Bay as revealed by otolith microchemistry analyses. Keisuke MATSUZAKI*, Kouki KANOU and Hiroshi KOHNO.
- 132 How do the fishes utilize the tidal flat in Tama River estuary, the inner Tokyo Bay? : Part III Changes of similarity and diversity indices. Yoshihiro KASE*, Masato MOTTEKI and Hiroshi KOHNO.
- 133 Adaptation of *Misgurnus mizolepis* for cutaneous respiration in burrows of ricefield from Korea. Min-ki OH* and Jong-Young PARK.
- 134 Relationship between male-male competition and nuptial coloration in pale chub *Zacco platypus*. Daisuke TAKAHASHI.
- 135 Spawning and egg-guarding behavior of ocellated icefish *Chionodraco rastrospinosus* (Perciformes, Channichthyidae) in an aquarium. Hiroshi NAKAMURA, Satoshi TADA*, Ryosuke MIMORI and Tetsuo IWAMI.
- 136 Effect of body size on reproductive success of dusky frillgoby nest-holder males. Shoma KAWASE*, Noriyosi SATO, Masaaki YOSHIDA and Takeshi TAKEGAKI.
- 137 Juvenile defense behavior by widowed male after removing females in polygynous, *Parapercis cylindrica*. Keita OGISO*, Tomoki SUNOBE, Tetsuo KUWAMURA, Shouhei SUZUKI and Tatsuru KADOTA.
- 138 Male mating tactics of *Oreochromis mossambicus* in a Japanese pond: territorial behavior, nuptial coloration and sex steroid hormones. Satoshi AWATA*, Tetsuya TSURUTA and Keiichiro IGUCHI.
- 139 A process from habitat research to preservation of local population, *Rhodeus ocellatus kurumeus*, in the A city, northern Kyushu, Japan. Tomonori KAWAMOTO* and Norio ONIKURA.
- 140 Relationship between freshwater mussel and longitudinal connectivity influencing host fish migration in agricultural canal networks. Shigeya NAGAYAMA*, Hiroyuki TAMAOKI, Junjiro NEGISHI, Manabu KUME and Yuichi KAYABA.
- 141 A proposal for 2nd redlist of freshwater fish in Nagano Prefecture and status of noteworthy species. Satoshi KITANO* and Satoshi YAMAMOTO.
- 142 Effects of instream obstructions on the movement of Japanese fluvial sculpin. Takaharu NATSUMEDA*, Hirohiko TAKESHIMA and Keiichiro IGUCHI.
- 143 Genetic diversity and homogeneity in an endangered populations of *Hypseleotris cyprinoides* on Okinawa Islands and Luzon Island. Shumpei TOMITA*, Shohei MATSUZAKI, Shin-ichiro OKA, Minoru TODA and Hideyuki IMAI.
- 144 Potential fish species pool and ichthyofauna of the three tributaries basins of Iwai River, Kitakami River Systems. Yusuke MIYAZAKI*, Masanori NAKAE and Hiroshi SENOU.
- 145 Population structure of minnows living in Sagami-gawa and Kanamegawa river estimated by control region sequence. Akito OOI*, Hidetaka SUMIKURA, Naoyuki SUGURO, Naoto HANZAWA, Motokazu ANDO, Hiroshi OGAWA and Takeshi SASAKI.
- 146 A trial of the Schale's method for *Ex situ* preservation of the striped bitterling *Acheilognathus cyanostigma*. Tetsuro KITAGAWA*, Yuka ODA, Hitomi YAMANO, Hiroaki TAKEUCHI, Kengo HATADA and Kazumi HOSOYA.
- 147 Effects of freshwater fish on the Great East Japan Earthquake: A case of threespine stickleback population in the Otsuchi Town, Iwate Prefecture, Japan. Manabu KUME*, Jun KITANO, Tetsuya SUMI, Shotaro NISHIDA and Seiichi MORI.

- 148 Genetic analysis of wild Medaka populations in Katsura River, Kyoto Prefecture, Japan. Ryohei NAKAO*, Yuka IGUCHI, Seigo KAWASE, Kazuhiro TANAKA, Kazumi HOSOYA and Tadao KITAGAWA.
- 149 Efforts to habitat conservation of the Japanese rosy bitterling population in Nara Prefecture, Japan. Tomotsugu SUGIMOTO*, Ryuya OKADA, Takuya NAKAYAMA, Ryuichi TSUNODA, Masaki TAKAO, Katsuhiko MIZUMOTO and Tadao KITAGAWA.
- 150 Examination of the re-introduction of the Host mussels for the endangered local population of the Japanese rosy bitterling in Nara Prefecture, Japan. Ryuya OKADA*, Ryota NOGUTI, Tomotugu SUGIMOTO, Keisuke TAKATA and Tadao KITAGAWA.
- 151 Age and growth of three species of *Lutjanus* in Okinawa-jima Island. Katsuya ARAKI* and Katsunori TACHIHARA.
- 152 Trace back to the sites of life and work of Phillip Franz von Siebold. Toshinobu ASAI*, Tomohiko MORIMUNE, Seigo KAWASE and Kazumi HOSOYA.

Lecture of the Awardees Oral Presentation

Room #1 (Hiyo Room, 3rd Floor, East Building) October 4 (Friday) 12:15-12:45

**Phylogeny and taxonomy of percomorph fishes with a focus on tetraodontiformes
Yusuke YAMANOUE**

Symposium

October 6 (Sunday)

Oral Presentation Room #1 (Hiyo Room, 3rd Floor, East Building)

Frontier analysis of biodiversity in fishes

Conveners: Norio ONIKURA, Ryutei INUI, and Takumi AKASAKA

Commentator: Futoshi NAKAMURA

- | | | |
|---|--------------|---|
| 1 | 9:00 - 9:15 | Introduction – Mapping of biodiversity
Futoshi NAKAMURA |
| 2 | 9:15 - 9:45 | Linking planning and practice with stream ecosystem management
Hiromune MITSUHASHI |
| 3 | 9:45 - 10:15 | Establishing database and niche models for freshwater fishes in Southeast Asia
Yuichi KANO*, Koichi SHIBUKAWA, Kenzo UTSUGI, Tomomi YAMASHITA, Tatsuro SATO, Yuta TOMIYAMA, and Yukihiro SHIMATANI |

<Short Break>

- 4 10:30 - 11:00 Habitat evaluation in multiple-scale for endangered Ryukyu-Ayu
Kazuaki OHTSUKI
- 5 11:00 - 11:30 Prediction of the distribution of estuarine gobiid fishes in Seto Inland Sea
Ryutei INUI
- 6 11:30 - 12:00 Random Forests as a tool to assess habitat suitability of seven bittering species in northern Kyushu, Japan
Shinji FUKUDA*, Marie YAMAGUCHI, Norio ONIKURA, Kazuaki HIRAMATSU, Masayoshi HARADA, and Jun NAKAJIMA

<Lunch Break>

- 7 13:15 - 13:45 Ecological assessment of stream ecosystems from distributions of focal species: lessons from Kiso, Nagara, Ibi river systems
Terutaka MORI*, Kimihiko UENO, Yukio ONODA, Hiroki TAKAOKA, and Yuichi KAYABA
- 8 13:45 - 14:15 Conservation strategies for fish diversity using complementary analysis: where should we set freshwater protected areas in the future?
Takumi AKASAKA*, Terutaka MORI, Yuya TAKEGAWA, Nobuo ISHIYAMA, Mikio INOUE, Hiromune MITSUHASHI, Yoichi KAWAGUCHI, Norio ONIKURA, Yo MIYAKE, Izumi KATANO, Hidetaka ICHIYANAGI and Futoshi NAKAMURA
- 9 14:15 - 14:45 What is a conservation priority of endangered fish in Satoyama ?
Mayu KONISHI*, Keisuke TAKATA and Kei'ichiro IGUCHI

<Short Break>

- 10 15:00 - 15:30 Consequences of the introduction of exotic and translocated species and future extirpations on the functional diversity of freshwater fish assemblages
Shin-ichiro S MATSUZAKI*, Takehiro SASAKI and Munemitsu AKASAKA
- 11 15:30 - 16:00 Possibility of predicting potential hybridization between two subspecies of *Rhodeus ocellatus*, native and exotic, for conservation of native populations in northern-middle Kyushu, Japan
Norio ONIKURA*, Tomonori KAWAMOTO, Jun NAKAJIMA, Takuya MIYAKE, Koichi KAWAMURA and Shinji FUKUDA
- 12 16:00 - 17:00 Discussion

Meeting Venue

MIYAZAKI KANKO HOTEL East Building (New Building)

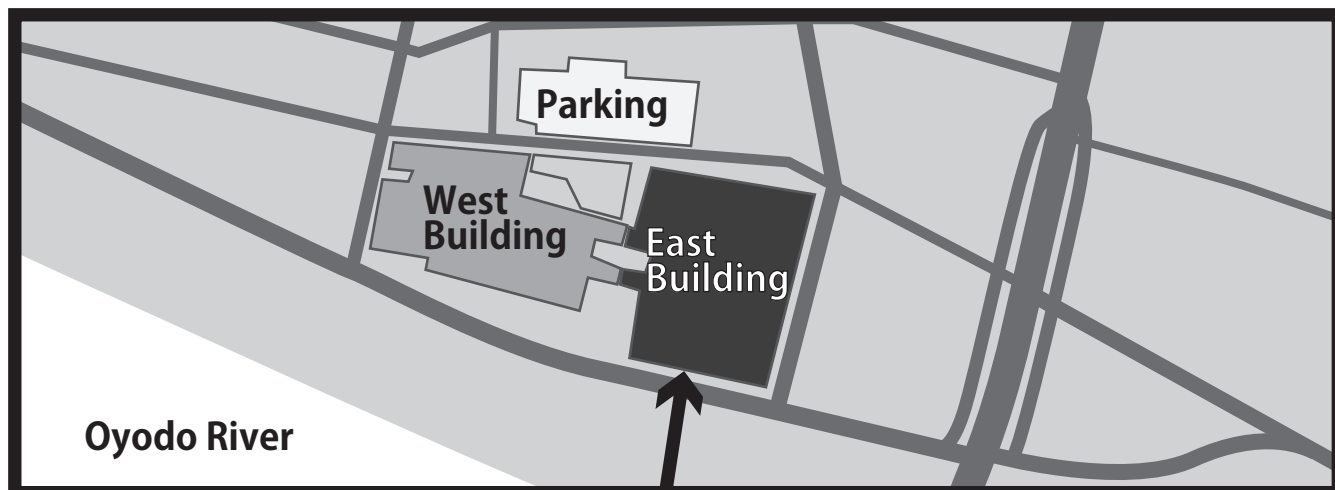

Oral and Poster Presentation and Banquet MIYAZAKI KANKO HOTEL East Building (New Building)

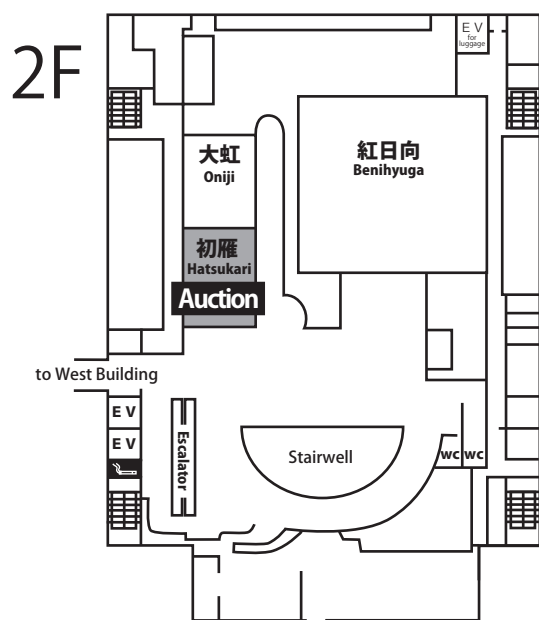
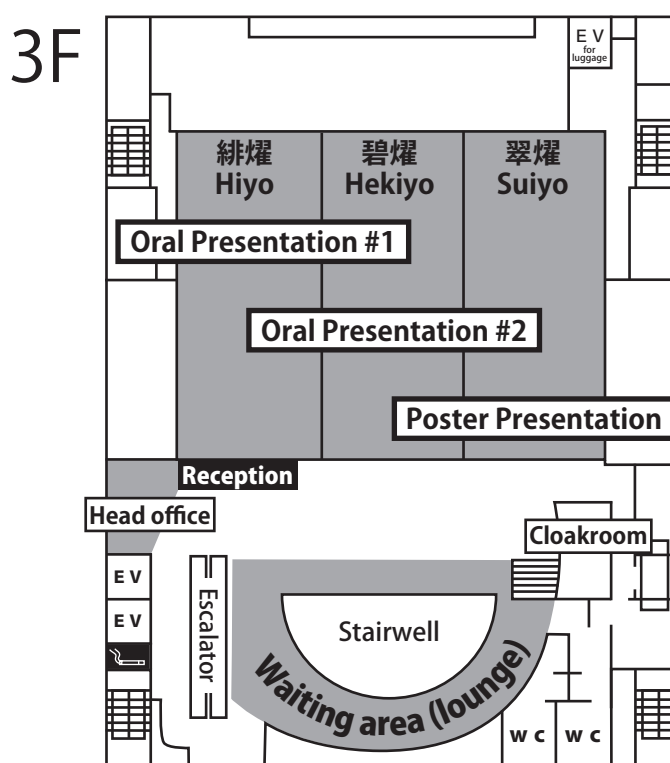
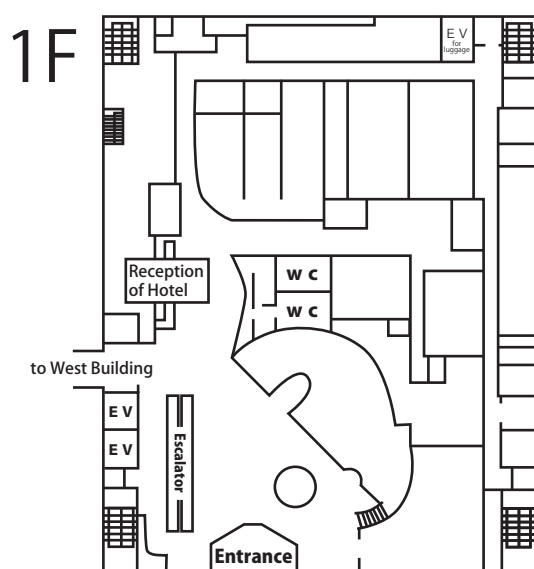

2 F	Auction	Hatsukari
3 F	Reception	front of Hiyo
	Oral Presentation#1	Hiyo
	Oral Presentation#2	Hekiyo
	Poster Presentation	Suiyo
	Banquet	Hiyo and Hekiyo
	Symposium	Hiyo
	Waiting area (lounge)	around stairwell